

G440CKSU...

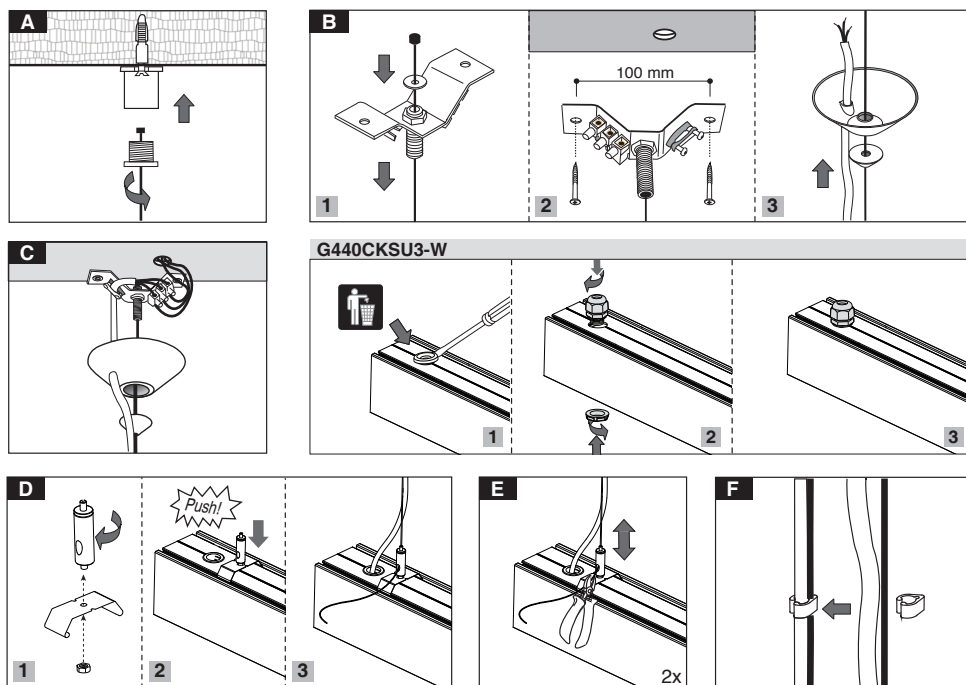

Cat. No	L	Number of installation kit
M440E601LED2AF...	580	2
M440E902LED2AF...	860	2
M440E1152LED2AF...	1140	2
M440E1453LED2AF...	1425	2
M440E1703LED2AF...	1705	2
M440E2004LED2AF...	1985	3
M440E2304LED2AF...	2265	3

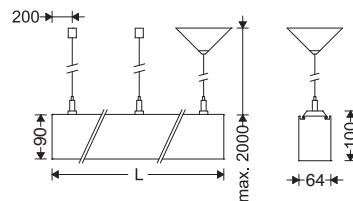

EN Instruction for Installation and Utilization of **INFINITY-E** Surface Mount Light Bar

7002016009

www.megalite.com info@megalite.com

Megalite
Crafted for Brilliance



- 1- For proper utilization of this product and for safety, it is mandatory to closely comply with the directions and notes in this installation and maintenance guide.
- 2- Earth connection as provided is mandatory.
- 3- Do not directly touch or impact LED module.
- 4- Do not stare at LED light source.

Cat. No	L	Number of installation bracket
M440E601LED2AF...	580	2
M440E902LED2AF...	860	2
M440E1152LED2AF...	1140	2
M440E1453LED2AF...	1425	2
M440E1703LED2AF...	1705	2
M440E2004LED2AF...	1985	3
M440E2304LED2AF...	2265	3

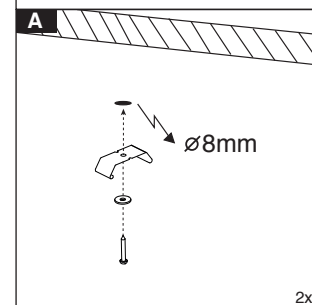
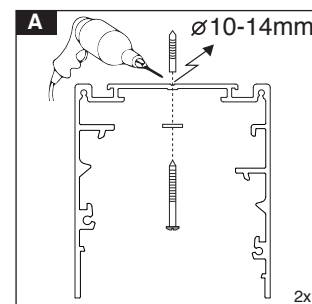
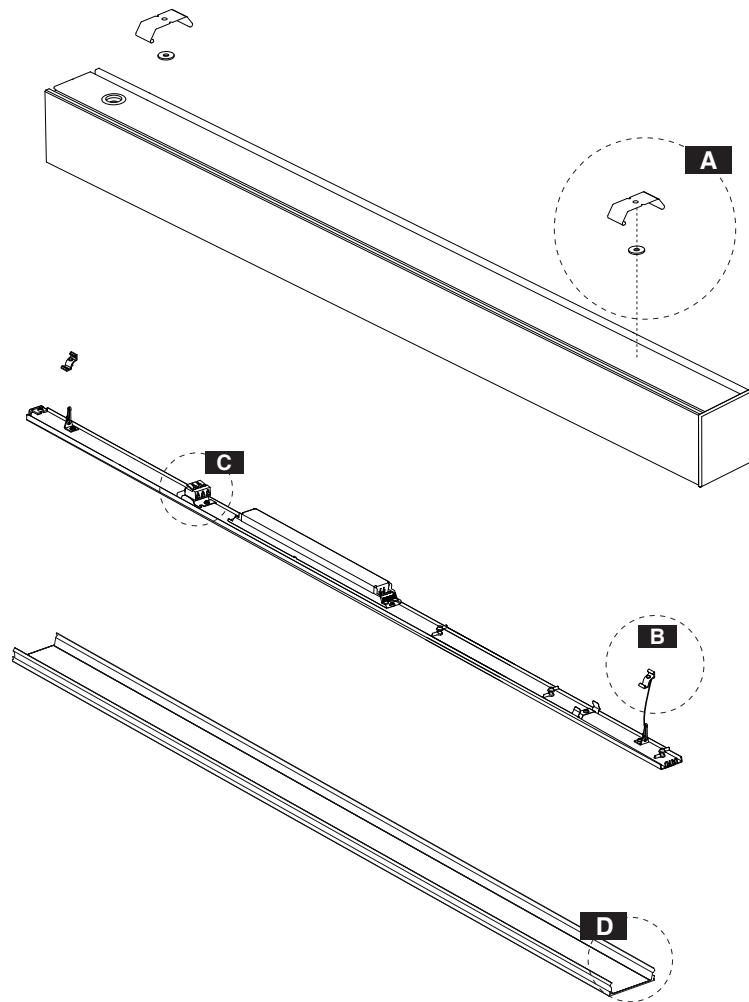

G440CKSF
Mounting brackets

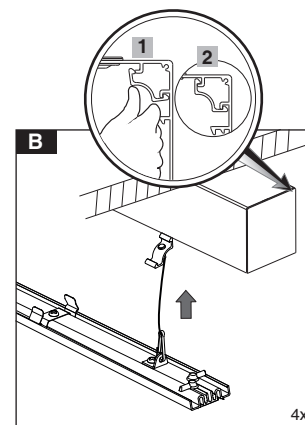
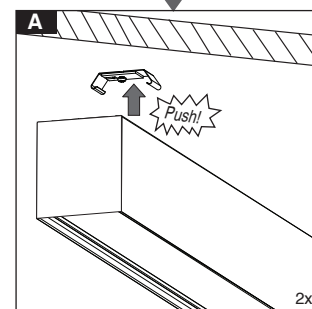

Gear tray suspension

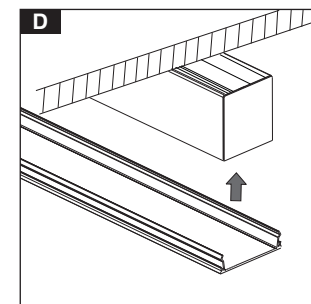

Diffuser mounting

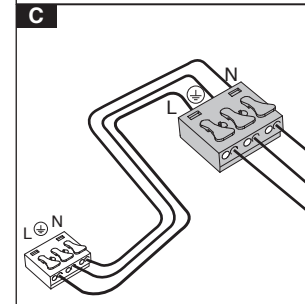
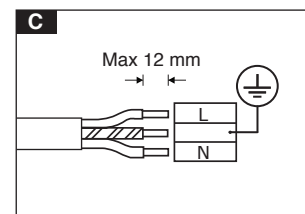

Gear tray to housing terminal wiring

7002014807

www.megalite.com info@megalite.com



- 1- For proper utilization of this product and for safety, it is mandatory to closely comply with the directions and notes in this installation and maintenance guide.
- 2- Earth connection as provided is mandatory.
- 3- Do not directly touch or impact LED module.
- 4- Do not stare at LED light source.



Attention!

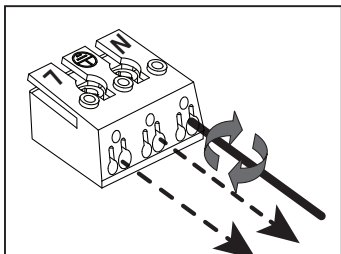

Dispart the wires from the last terminal at the end

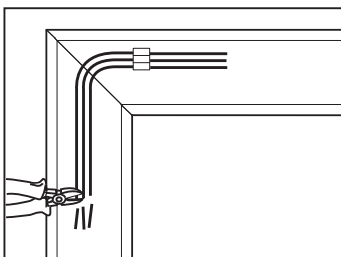

Cut the terminal wires as needed at the jointed connectors.

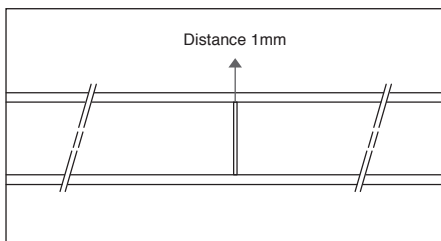

Consider 1mm space between housing profile and diffuser in every 3m luminaire length

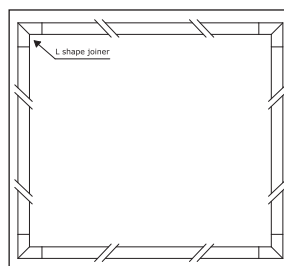

Gear tray placement

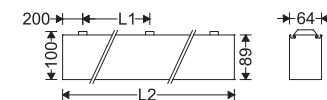
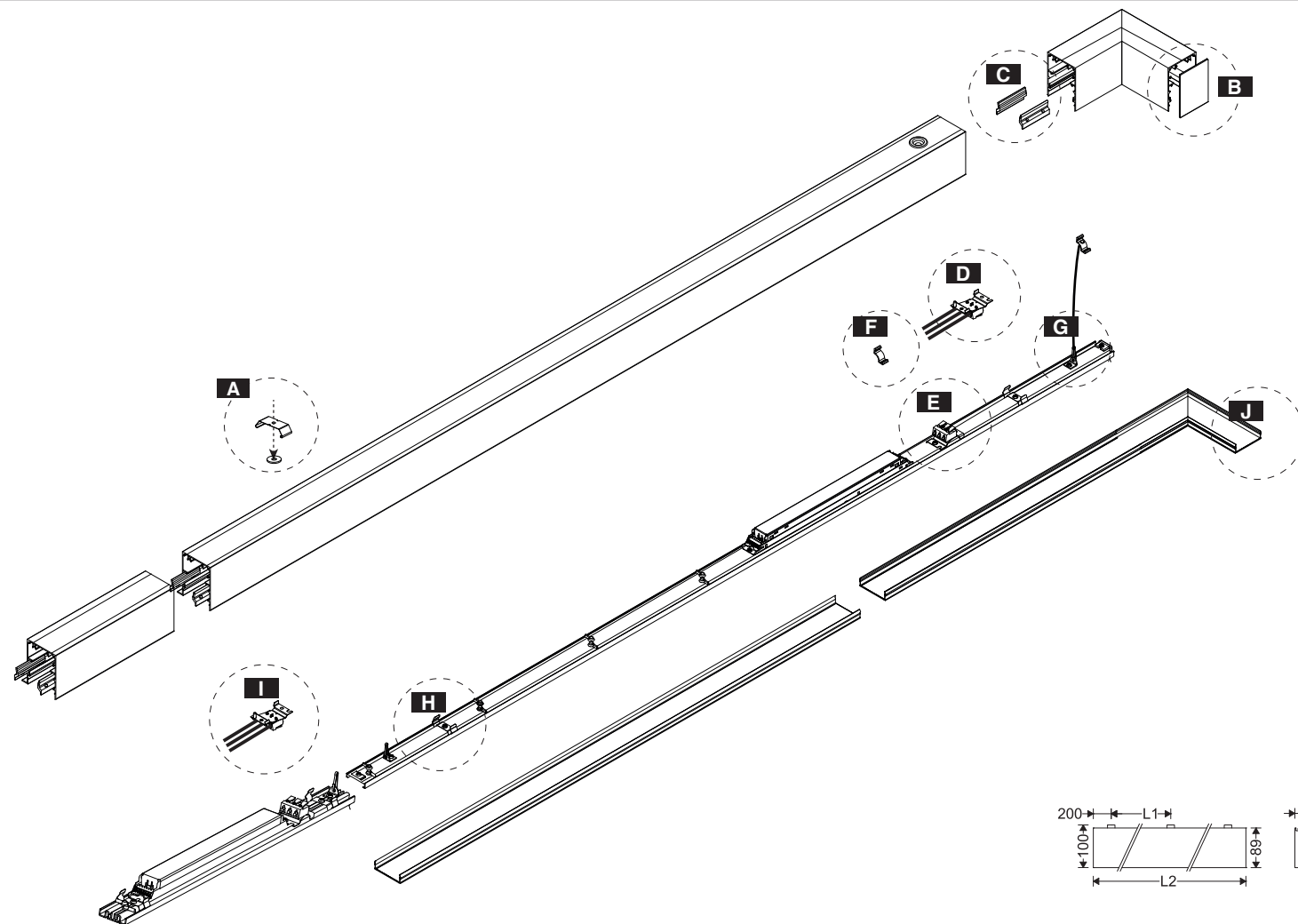

$$N = (L2 / L1) + 1$$

$$L1 = 1200 - 1800$$

$$L3 = \text{MIN.} = 200 / \text{MAX.} = L1 / 2$$

$$\text{Example: } L2 = 10000, L1 = 1500 \rightarrow N = \frac{10000}{1500} = 6.666$$

$$L3 = (0.666 * 1500) / 2 = 250\text{mm}$$

$$\text{Number of Installation Kit \& bracket: } 1 + 6 = 7$$

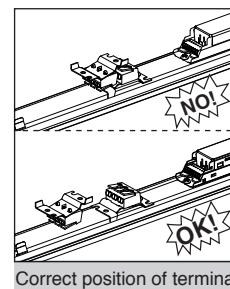

Correct position of terminal



While mounting the terminal to the housing of luminaire, be notified that it must not be placed across from the mounted terminal and driver on the gear tray.

G440CKSF Mounting brackets

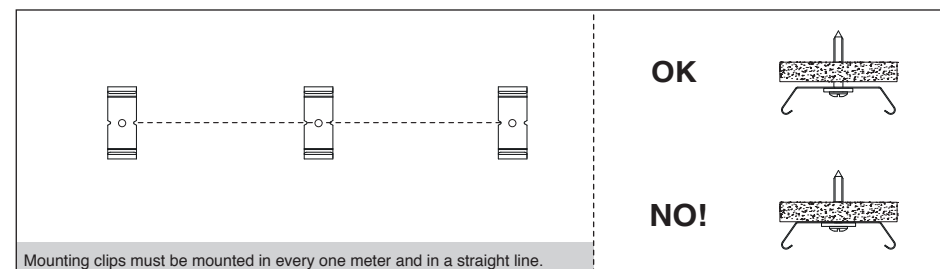
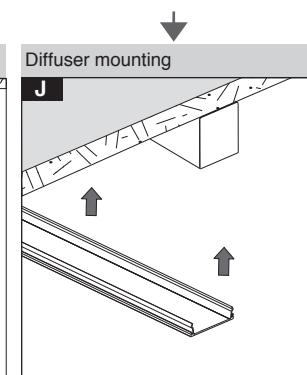
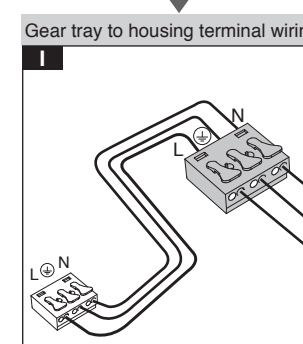
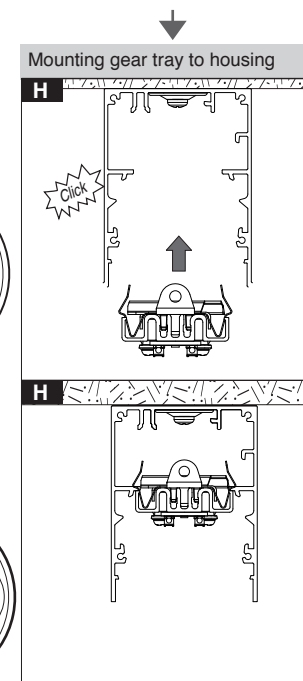
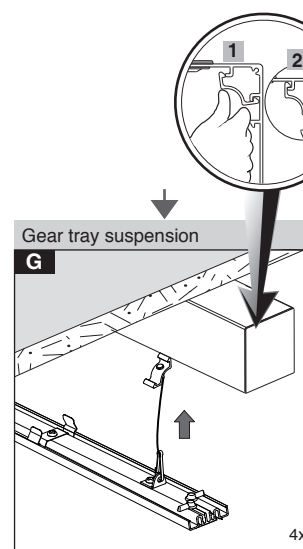
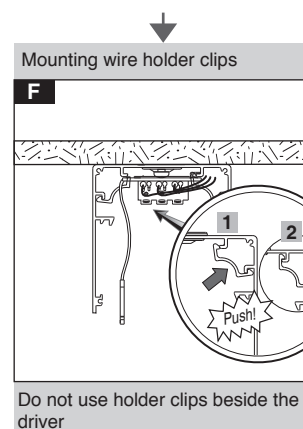
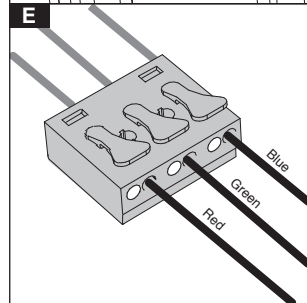
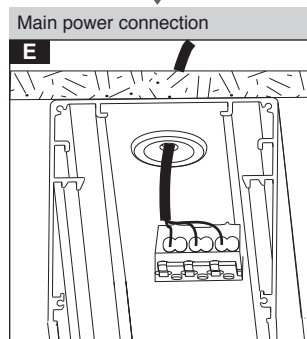
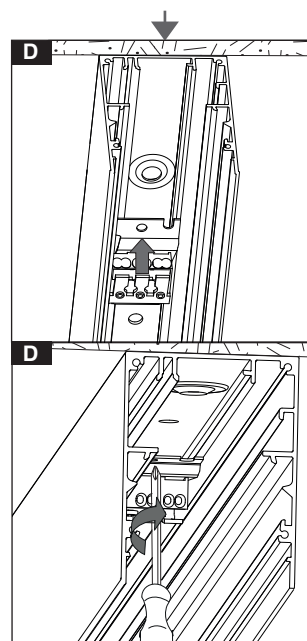
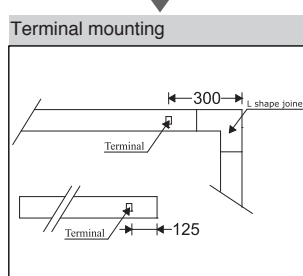
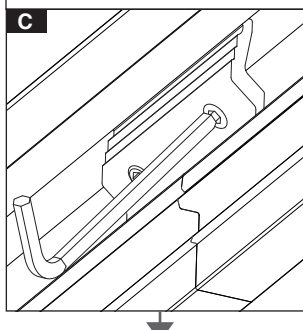
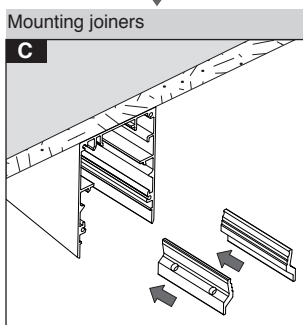
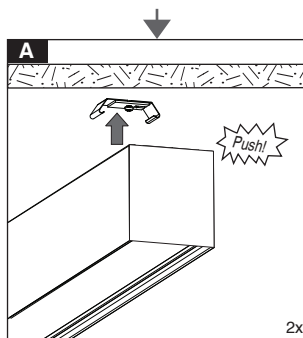
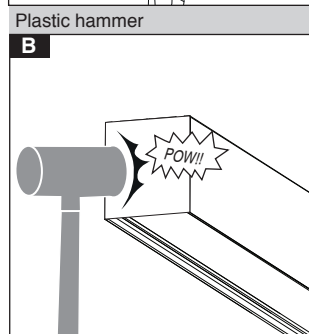
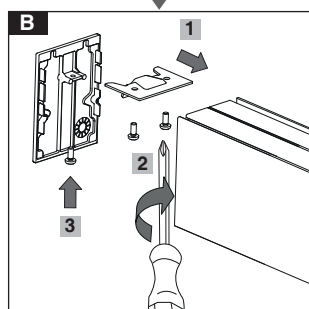
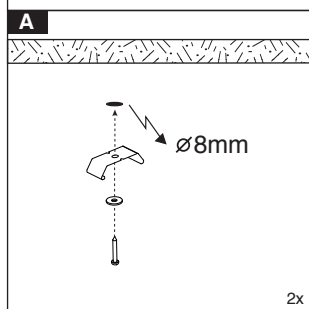
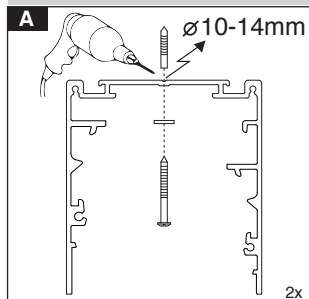

Uneven ceiling

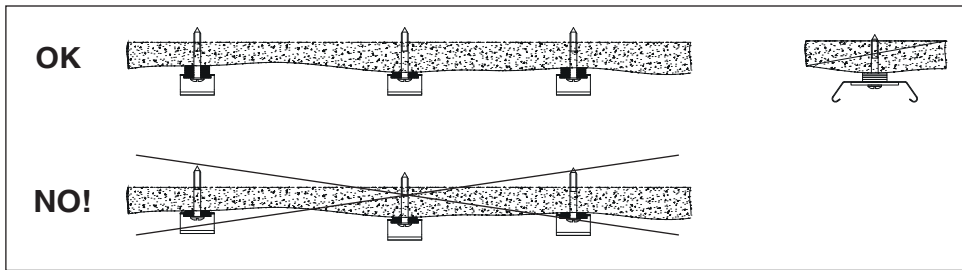

G440CKSU...

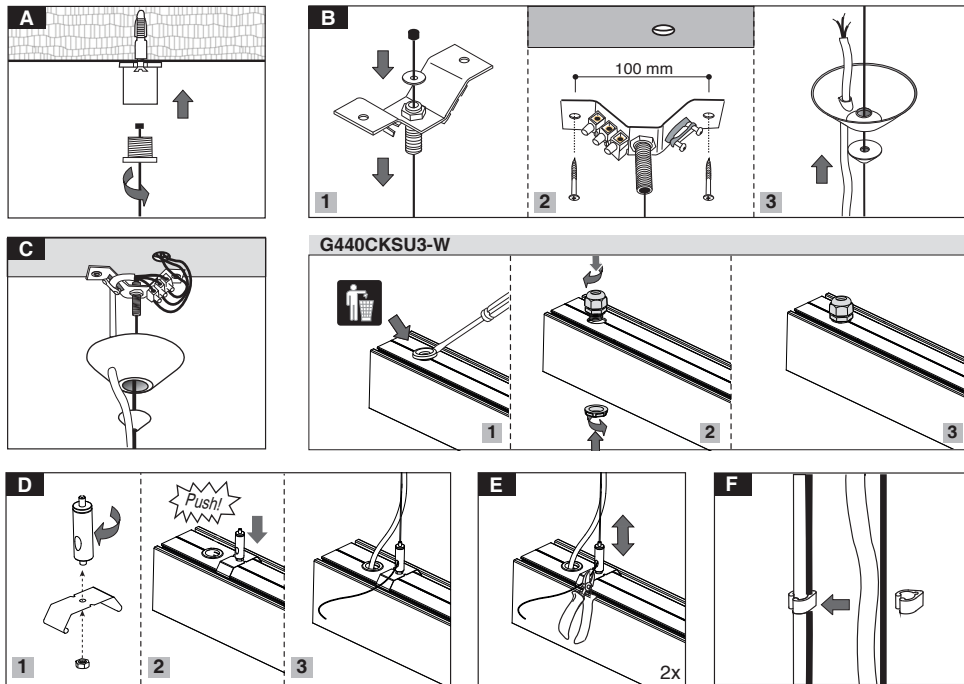

$$N = (L2 / L1) + 1$$

$$L1 = 1200 - 1800$$

$$L3 = \text{MIN.} = 200 / \text{MAX.} = L1 / 2$$

$$\text{Example: } L2 = 10000, L1 = 1500 \rightarrow N = \frac{10000}{1500} = 6.666$$

$$L3 = (0.666 \times 1500) / 2 = 250 \text{ mm}$$

Number of Installation Kit: $1 + 6 = 7$

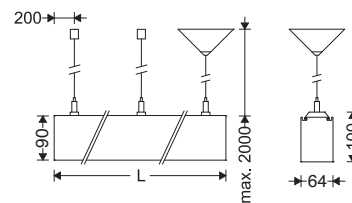

7002015504

www.megalite.com info@megalite.com



- 1- For proper utilization of this product and for safety, it is mandatory to closely comply with the directions and notes in this installation and maintenance guide.
- 2- Earth connection as provided is mandatory.
- 3- Do not directly touch or impact LED module.
- 4- Do not stare at LED light source.



Attention!

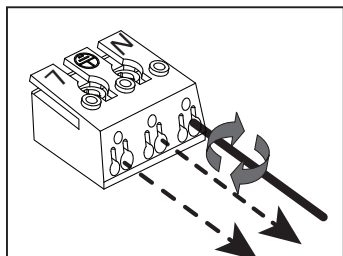

Dispart the wires from the last terminal at the end

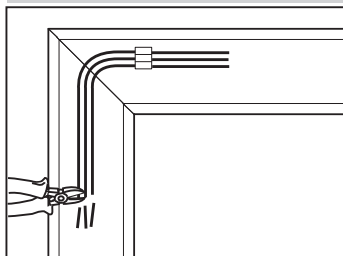

Cut the terminal wires as needed at the joined connectors.

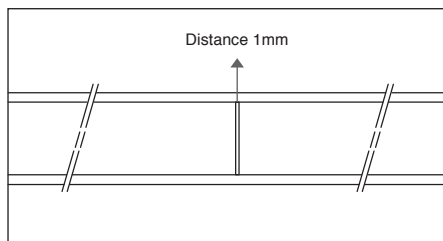

Consider 1mm space between housing profile and diffuser in every 3m luminaire length

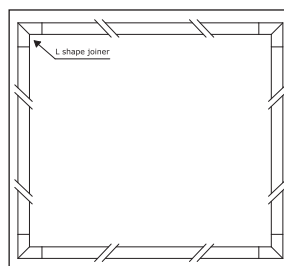

Gear tray placement

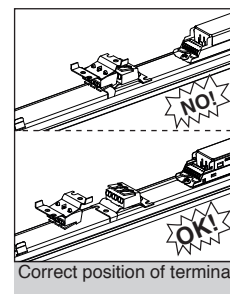
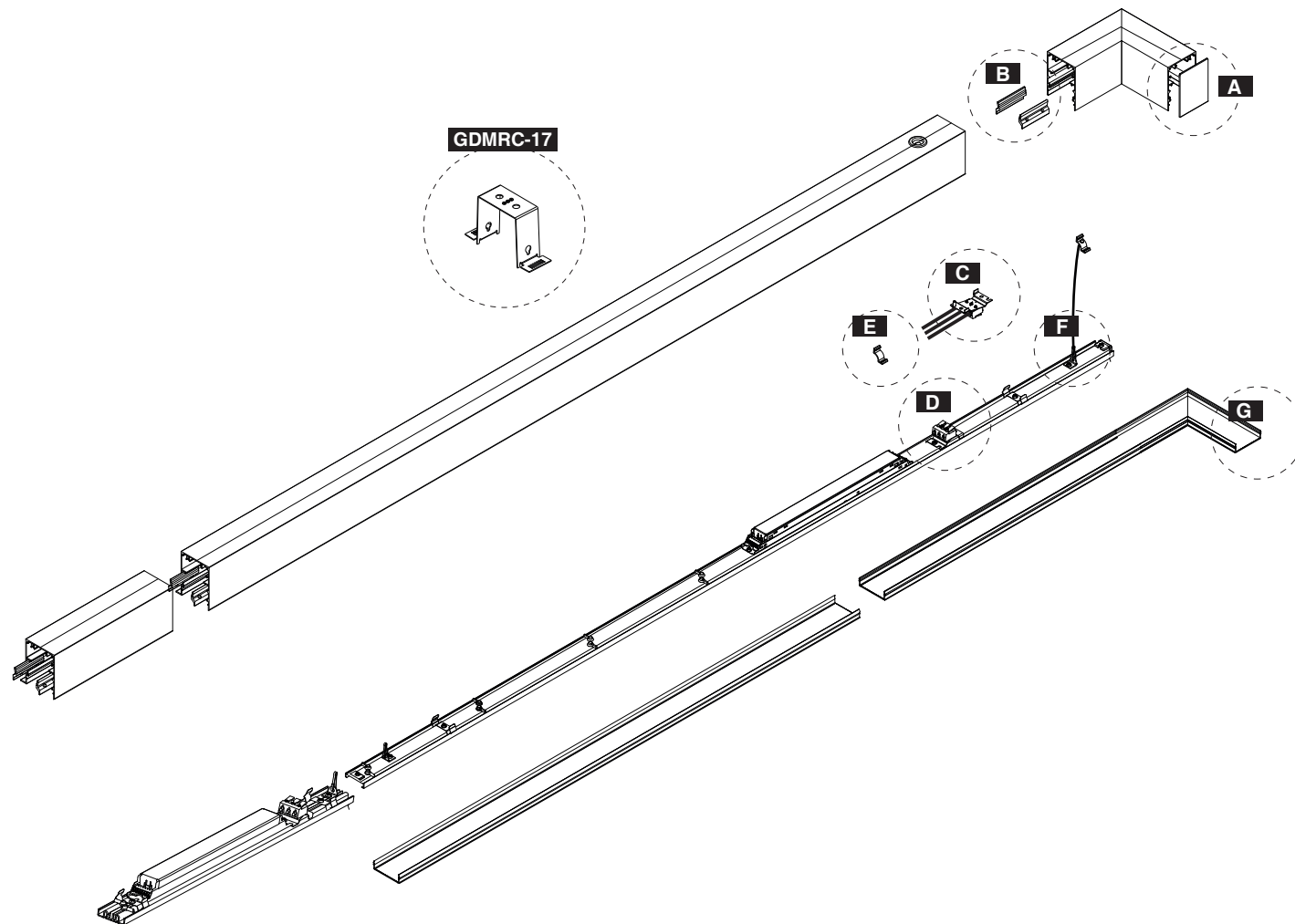

Correct position of terminal



While mounting the terminal to the housing of luminaire, be notified that it must not be placed across from the mounted terminal and driver on the gear tray.

GDMRC-17

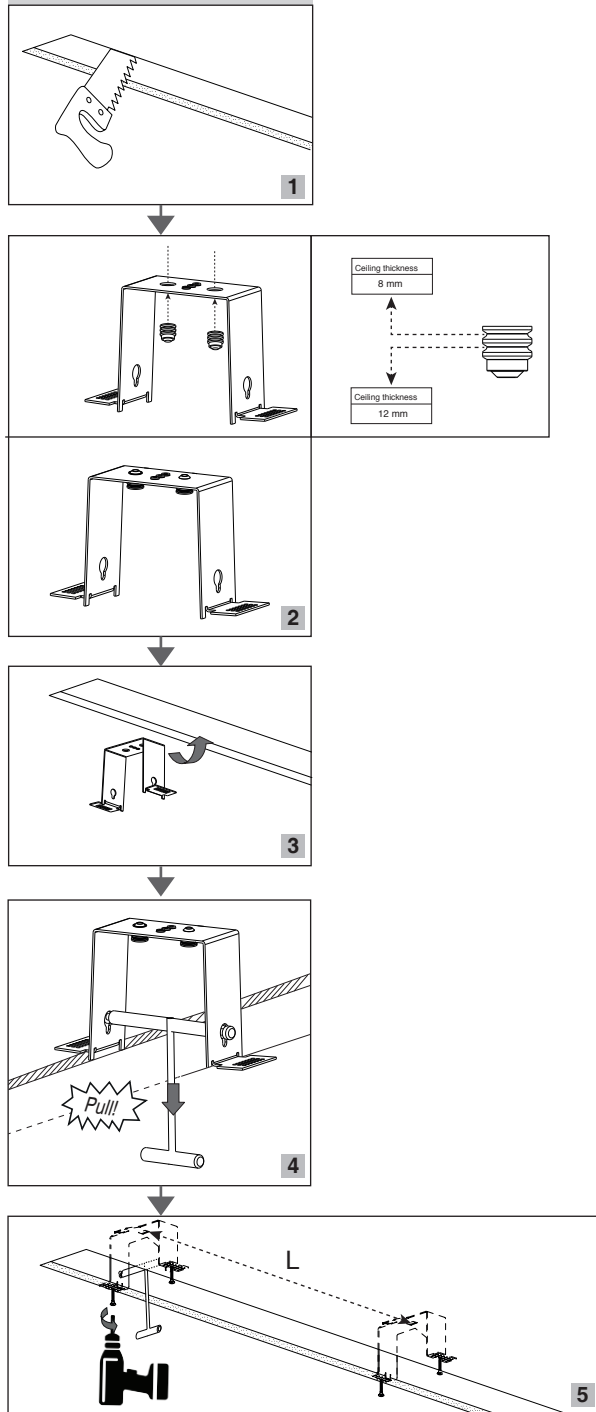

3

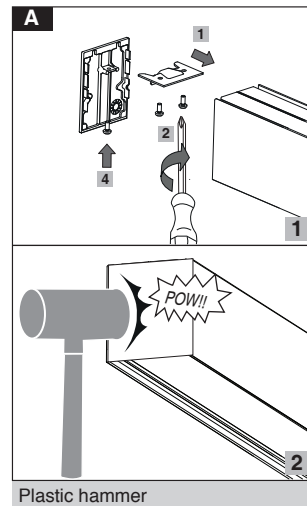

Mounting the luminaire

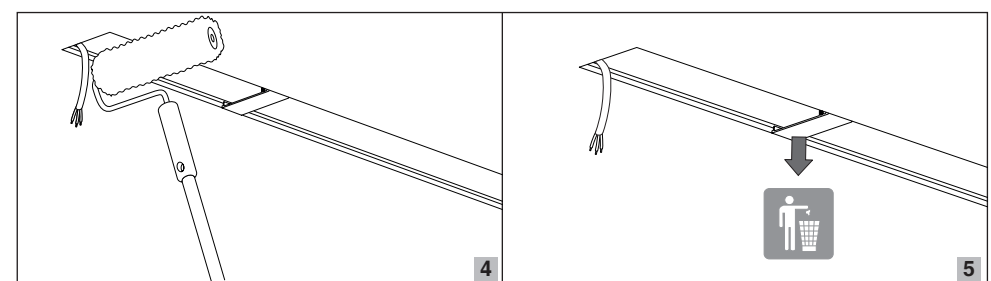
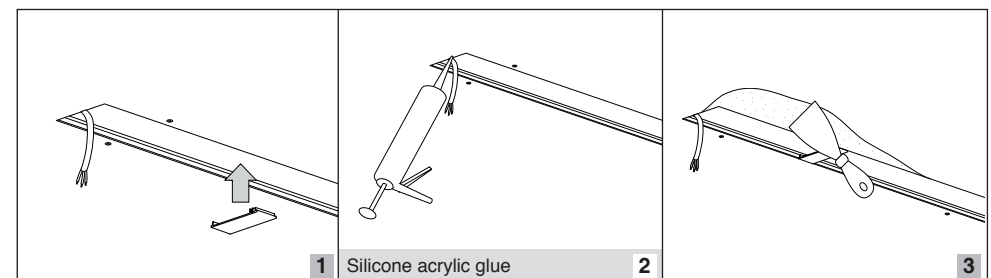
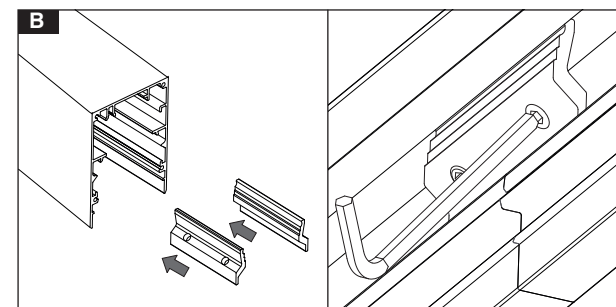
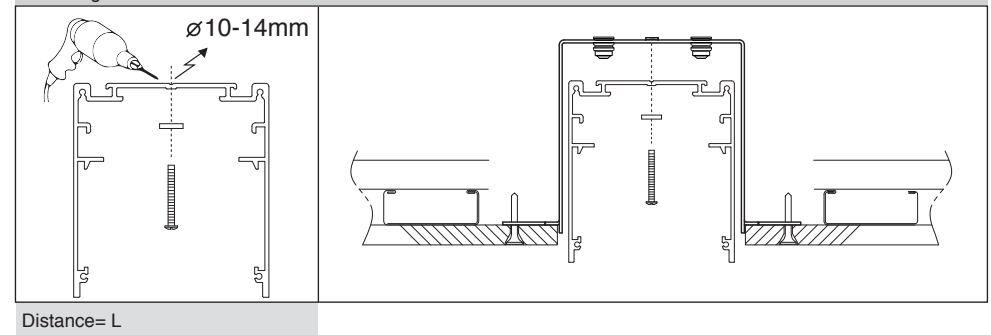

4

