

EN Instruction for Installation and Utilization of **HERCULED** Industrial Luminaire

7002015810

www.megalite.com info@megalite.com



Cat. No.	W (kg)
M312S...LED6...-S	5.6
M312S...LED7...-S	5.7
M312...LED9...-S	8.5
M312...LED10...-S	8.5

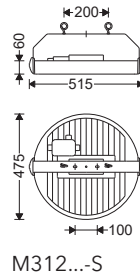
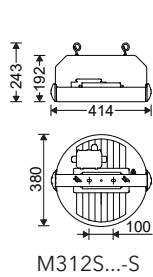

- !**
- 1- For proper utilization of this product and safety, it is mandatory to closely comply with the directions and notes in this instruction and guide.
  - 2- Earth connection as provided is mandatory.
  - 3- Do not directly touch or impact LED module.
  - 4- Do not stare at LED light source.
  - 5- The light source contained in this luminaire shall only be replaced by the manufacturer or his service agent or a similar qualified person. Always switch off the power prior to installation, maintenance or repair activities.
  - 6- Suitable only for indoor applications

